

NP12-70Ah 12V70Ah



Specifications

| | | |
|-------------------------------|--------------------|--------------------|
| Nominal Voltage | 12V | |
| Rated capacity (10 hour rate) | 70Ah | |
| Dimensions | Length | 260±2mm(10.24inch) |
| | Width | 168±2mm(6.61inch) |
| | Height | 211±2mm(8.31inch) |
| | Total Height | 215±2mm(8.46inch) |
| Approx. Weight | 22.5kg(49.6lbs)±3% | |

Outer dimensions (mm)

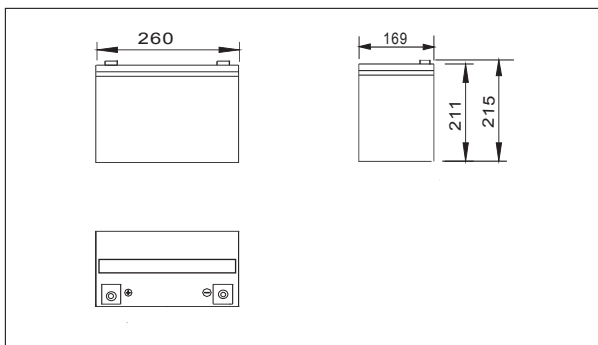

Terminal Type (mm)

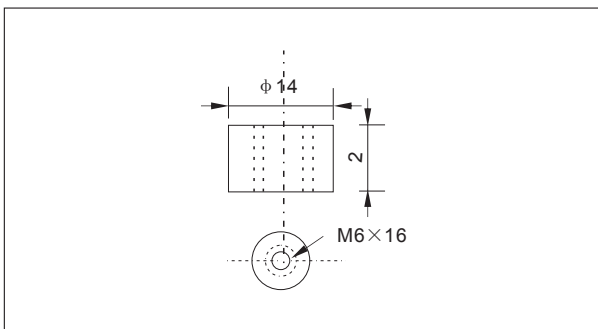

Construction

| Component | Positive plate | Negative plate | Container | Cover | Separator | Electrolyte | Safety valve | Terminal |
|--------------|----------------|----------------|-----------|-------|-----------|---------------|--------------|----------|
| Raw material | Lead dioxide | Lead | ABS | ABS | AGM | Sulfuric acid | Rubber | Copper |

Constant Current Discharge Characteristics Unit:A(25°C,77°F)

| F.V/Time | 10min | 15min | 30min | 60min | 2h | 3h | 4h | 5h | 8h | 10h | 20h |
|----------|-------|-------|-------|-------|------|------|------|------|------|------|------|
| 9.60V | 153 | 118 | 70.4 | 43.3 | 25.6 | 18.4 | 14.7 | 12.6 | 8.64 | 7.13 | 3.78 |
| 9.90V | 148 | 115 | 68.9 | 42.6 | 25.4 | 18.3 | 14.6 | 12.5 | 8.59 | 7.11 | 3.77 |
| 10.2V | 142 | 111 | 66.8 | 41.5 | 25.2 | 18.2 | 14.5 | 12.4 | 5.53 | 7.09 | 3.76 |
| 10.5V | 136 | 107 | 65.2 | 40.2 | 24.8 | 18.1 | 14.4 | 12.3 | 8.47 | 7.05 | 3.74 |
| 10.8V | 128 | 101 | 62.8 | 38.9 | 24.2 | 17.5 | 14.0 | 12.0 | 8.22 | 7.00 | 3.71 |

Constant Power Discharge Characteristics Unit:W(25°C,77°F)

| F.V/Time | 10min | 15min | 30min | 60min | 2h | 3h | 4h | 5h | 8h | 10h | 20h |
|----------|-------|-------|-------|-------|-----|-----|-----|-----|------|------|------|
| 9.60V | 1648 | 1291 | 789 | 493 | 296 | 217 | 173 | 149 | 103 | 85.1 | 45.3 |
| 9.90V | 1599 | 1260 | 774 | 486 | 294 | 215 | 172 | 148 | 102 | 84.9 | 45.2 |
| 10.2V | 1533 | 1214 | 750 | 473 | 292 | 214 | 171 | 147 | 101 | 84.7 | 45.1 |
| 10.5V | 1467 | 1172 | 732 | 459 | 287 | 212 | 170 | 146 | 101 | 84.2 | 44.8 |
| 10.8V | 1384 | 1110 | 705 | 444 | 280 | 206 | 164 | 141 | 97.6 | 83.6 | 44.5 |

Note: The above characteristics data can be obtained within three charge or discharge cycles.

Characteristics

| | | |
|--|-------------|---|
| Capacity (25°C) | 10HR(10.8V) | 70Ah |
| | 3HR(10.8V) | 52.5Ah |
| | 1HR(10.5V) | 39Ah |
| Terminal type | | T14 |
| Internal resistance (Fully charged,25°C) | | Approx.6m Ω |
| Capacity affected by temperature (10HR) | 40°C | 102% |
| | 25°C | 100% |
| | 0°C | 85% |
| | -15°C | 65% |
| Self-discharge (25°C) | 3month | Remaining Capacity:91% |
| | 6month | Remaining Capacity:82% |
| | 12month | Remaining Capacity:65% |
| Nominal operating temperature | | 25°C ±3°C(77°F ±5°F) |
| Operating temperature range | Discharge | -15°C~50°C(5°F~122°F) |
| | Charge | -10°C~50°C(14°F~122°F) |
| | Storage | -20°C~50°C(-4°F~122°F) |
| Float charging voltage(25°C) | | 13.50 to 13.80V Temperature compensation: -18mV/°C |
| Cyclic charging voltage(25°C) | | 14.50 to 15.00V Temperature compensation: -30mV/°C |
| Maximum charging current | | 21A |
| Terminal material | | Copper |
| Maximum discharge current | | 700A(5 sec.) |
| Designed floating life(20°C) | | 10years |

NP12-70Ah 12V70Ah

● Discharge characteristics(25°C)



● Charging characteristics (25°C)

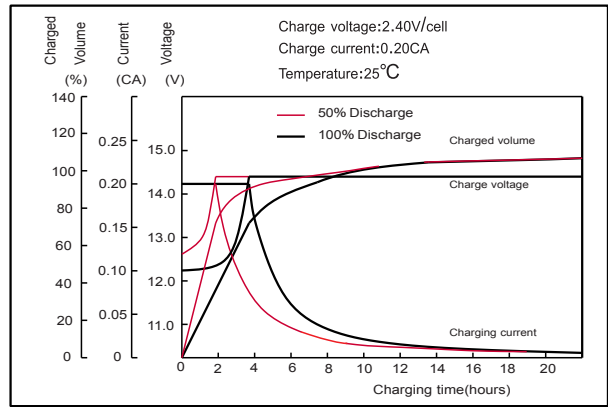

● Temperature effects on Capacity

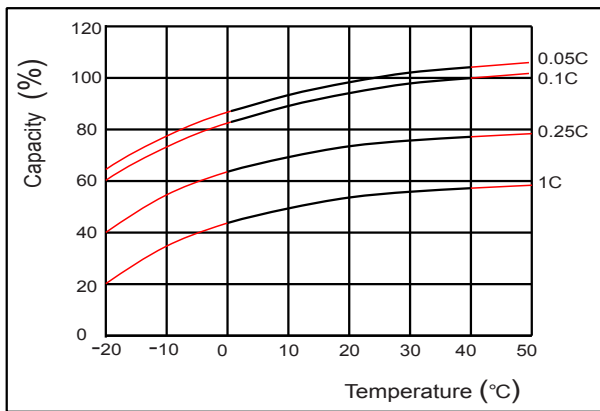

● Self-discharge characteristics

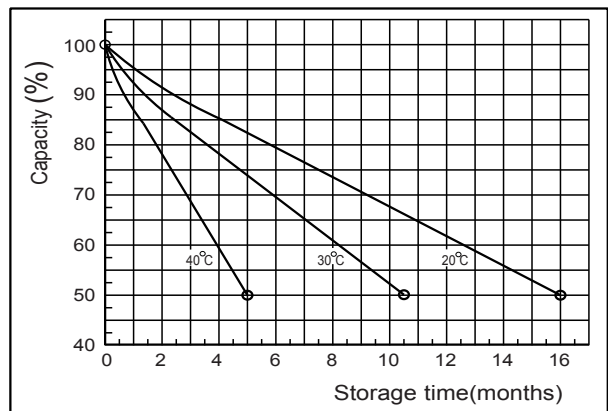

● Floating life on Temperature

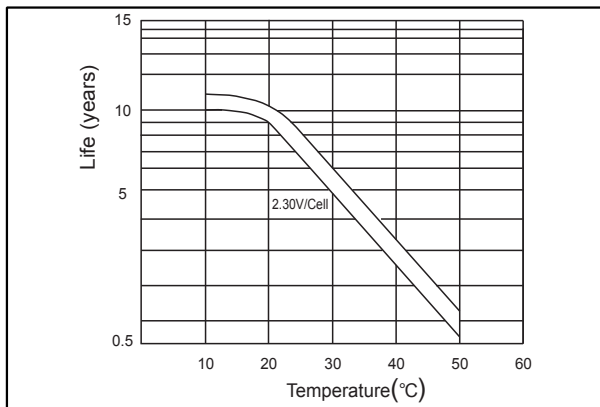

● Cycle life on D.O.D (25°C)

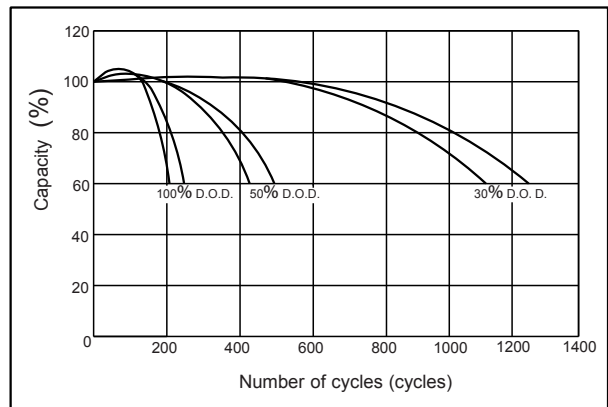

● The relationship for OCV and Capacity (25°C)

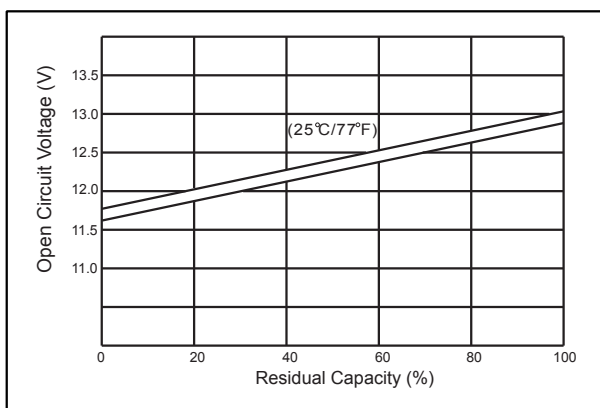

● The relationship for Charging voltage and Temperature

