

## HR12130W (12V130 Watts/cell)



### Specifications

Nominal Voltage	12V	
Number of cell	6 cells	
Rated capacity(15min.rat)	130 Watts/cell	
Dimensions	Length	195±2mm(7.68inch)
	Width	130±2mm(5.12inch)
	Height	155±2mm(6.10inch)
	Total Height	167±2mm(6.57inch)
Approx. Weight	11.5kg(25.4lbs)±3%	

### Outer dimensions (mm)

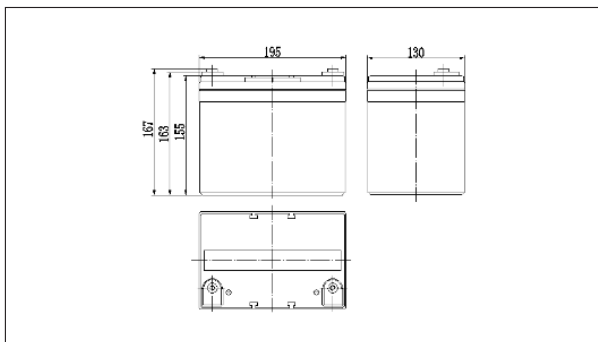

### Terminal Type (mm)

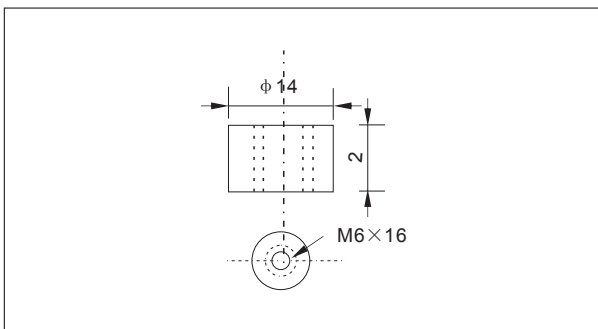

### Construction

Component	Positive plate	Negative plate	Container	Cover	Separator	Electrolyte	Safety valve	Terminal
Raw material	Leaddioxide	Lead	ABS	ABS	AGM	Sulfuric acid	Rubber	Copper

### Constant Current Discharge Characteristics Unit:A(25°C,77°F)

F.V/Time	10min	15min	20min	30min	45min	60min	2h	3h	4h	5h	6h
1.60V/cell	84.9	69.5	55.6	39.4	29.3	23.9	12.1	8.65	6.97	6.06	5.18
1.67V/cell	81.1	67.4	53.4	38.1	28.4	23.3	12.0	8.57	6.91	6.01	5.14
1.70V/cell	79.0	65.3	52.3	37.4	27.9	23.0	11.9	8.54	6.88	5.98	5.12
1.75V/cell	75.6	63.1	50.5	36.5	27.2	22.5	11.7	8.48	6.83	5.94	5.08
1.80V/cell	71.4	59.8	47.8	35.2	26.2	21.8	11.4	8.23	6.63	5.76	4.93

### Constant Power Discharge Characteristics Unit:W(25°C,77°F)

F.V/Time	10min	15min	20min	30min	45min	60min	2h	3h	4h	5h	6h
1.60V/cell	160	134	107	76.0	56.6	46.2	23.5	17.0	13.7	12.0	10.3
1.67V/cell	153	130	103	73.6	54.8	45.0	23.3	16.9	13.6	11.9	10.2
1.70V/cell	149	126	101	72.2	53.8	44.4	23.2	16.8	13.6	11.8	10.1
1.75V/cell	142	122	97.4	70.5	52.5	43.5	22.8	16.7	13.5	11.8	10.1
1.80V/cell	134	115	92.3	67.9	50.6	42.1	22.2	16.2	13.1	11.4	9.76

Note: The above characteristics data can be obtained within three charge or discharge cycles.

### Characteristics

Capacity(10HR,25°C)	33Ah	
Capacity(15min.rate,25°C)	130 Watts/cell	
Terminal type	T14	
Internal resistance (Fully charged,25°C)	Approx.8m Ω	
Capacity affected by temperature (10HR)	40°C	102%
	25°C	100%
	0°C	85%
	-15°C	65%
Self-discharge (25°C)	3month	Remaining Capacity:91%
	6month	Remaining Capacity:82%
	12month	Remaining Capacity:65%
Nominal operating temperature	25°C ±3°C(77°F ±5°F)	
Operating temperature range	Discharge	-15°C~50°C(5°F~122°F)
	Charge	-10°C~50°C(14°F~122°F)
	Storage	-20°C~50°C(-4°F~122°F)
Float charging voltage(25°C)	13.50 to 13.80V Temperature compensation: -18mV/°C	
Cyclic charging voltage(25°C)	14.50 to 15.00V Temperature compensation: -30mV/°C	
Maximum charging current	9.9A	
Terminal material	Copper	
Maximum discharge current	330A(5 sec.)	
Designed floating life(20°C)	10years	

## HR12130W (12V130 Watts/cell)

### ● Discharge characteristics(25°C)

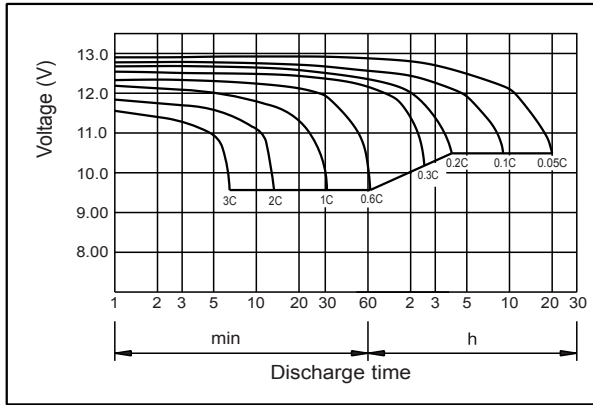

### ● Charging characteristics (25°C)

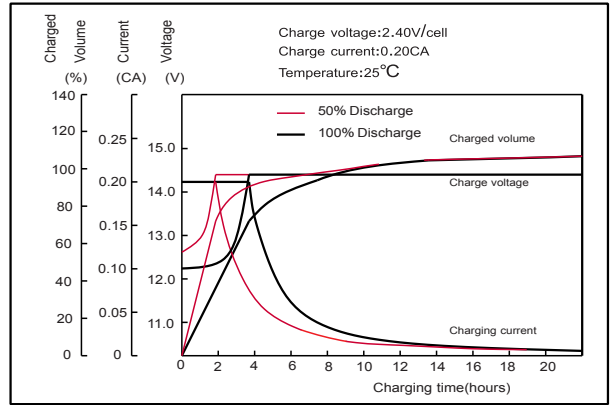

### ● Effect of Temperature on Capacity

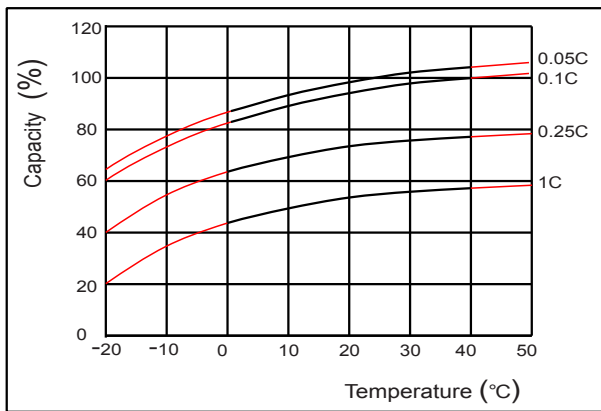

### ● Self-discharge characteristics

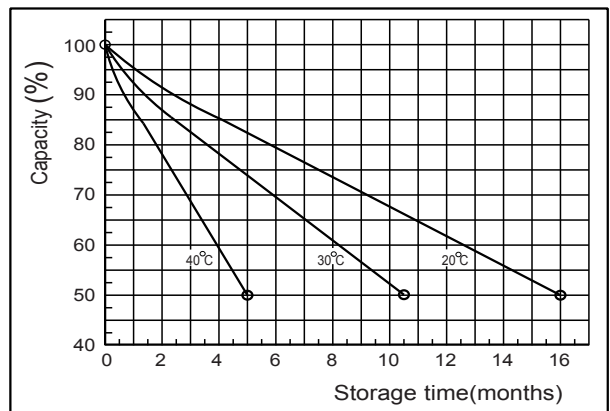

### ● Floating Life on Temperature

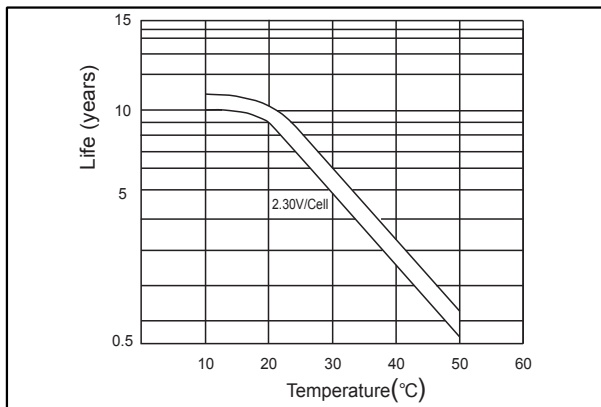

### ● Cycle service Life on D.O.D (25°C)

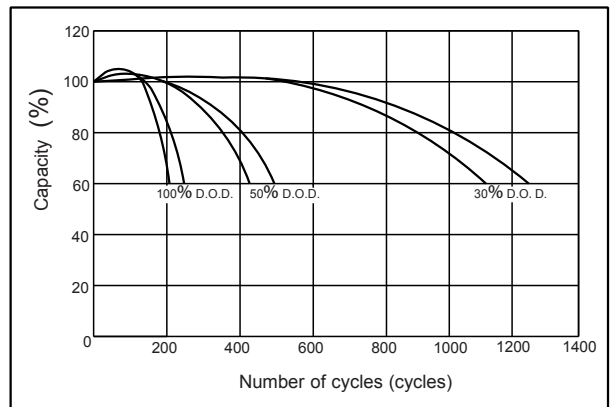

### ● The relationship for OCV and Capacity (25°C)

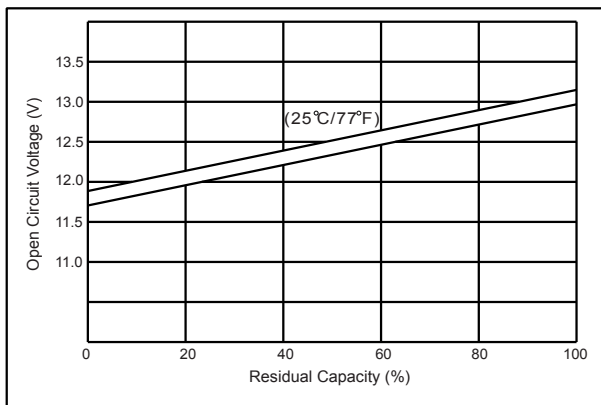

### ● The relationship for Charging voltage and Temperature

